

E

## Feature:

Widely accepted in the market, suitable for both liquids and gases.  
Easy to use, high visibility scale  
Gas or liquid flow measurement  
Simple and reliable  
Operator confidence from float rotation

- Temperature limit: 60°C,
- Accuracy:  $\pm 5\%$
- Working pressure limit: 0.6MPa

## Specifications

Model	Measuring range		Thread (Female)	Weights KG
	Water (mL/min)	Air (NL/min)		
K-1011	20-200	0.3-3	1/8"NPT *	0.5
K-1012	30-300	0.5-5	1/4" NPT	
K-1013	50-500	1-10	1/4"NPT 1/4"BSP	
K-1014	0.1-1 L/min	2-20		
K-1015	0.15-1.5 L/min	3-30		
K-1016	0.2-2 L/min	5-50		

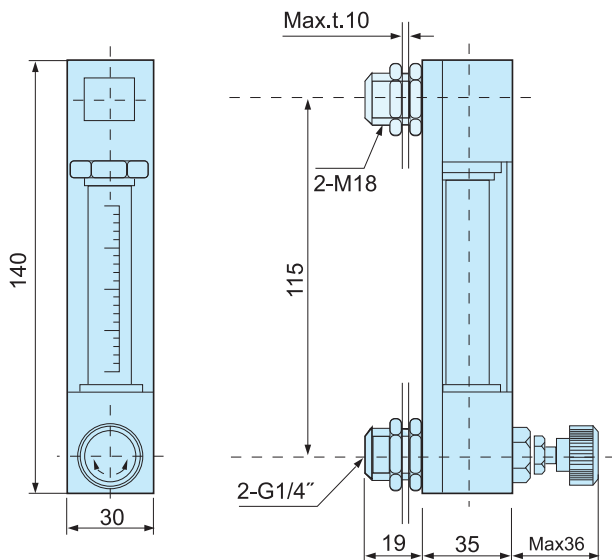

## K-100

## How to order

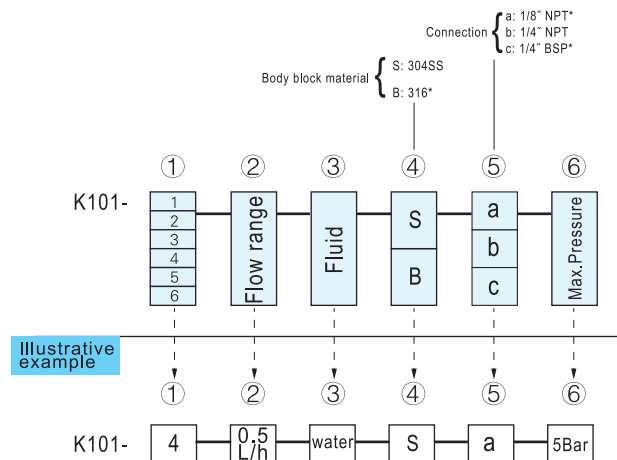

# K-200 Series

## Glass Rotameters

### Feature:

Widely accepted in the market, suitable for both liquids and gases.  
 Easy to use, high visibility scale  
 Gas or liquid flow measurement  
 Simple and reliable  
 Operator confidence from float rotation

- Temperature limit: 60°C,
- Accuracy:  $\pm 5\%$
- Working pressure limit: 0.6MPa

### Specifications

Model	Measuring range		Thread (Female)	Weights KG
	Water (mL/min)	Air (NL/min)		
K-2011	20-200	0.3-3	1/8"NPT *	0.5
K-2012	30-300	0.5-5	1/4" NPT	
K-2013	50-500	1-10	1/4"NPT 1/4"BSP	
K-2014	0.1-1 L/min	2-20		
K-2015	0.15-1.5 L/min	3-30		
K-2016	0.2-2 L/min	5-50		

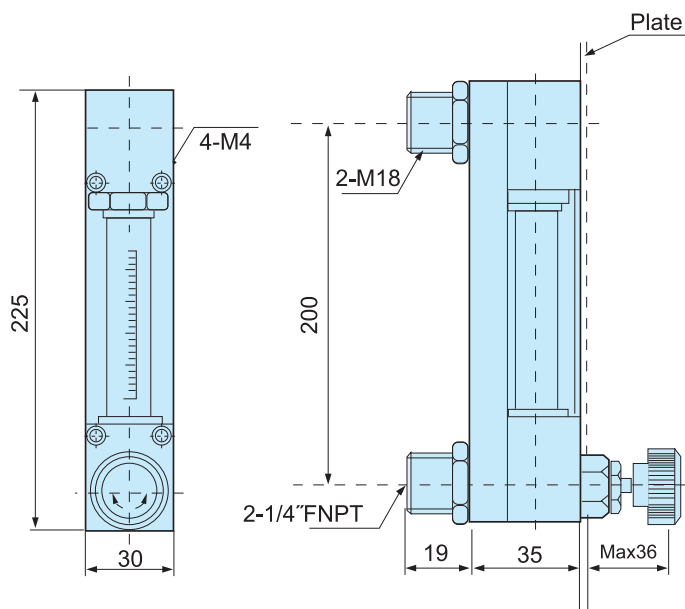
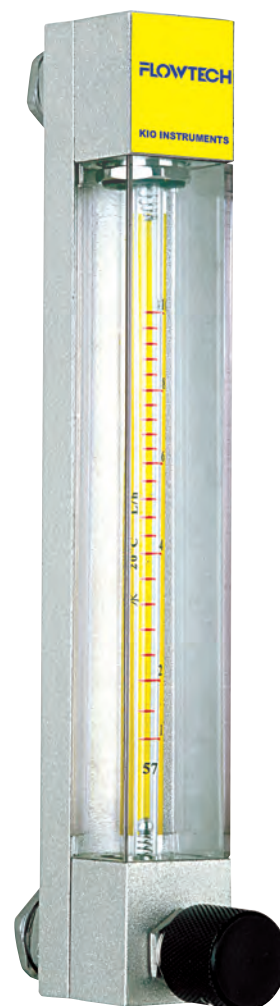

### K-200

### How to order

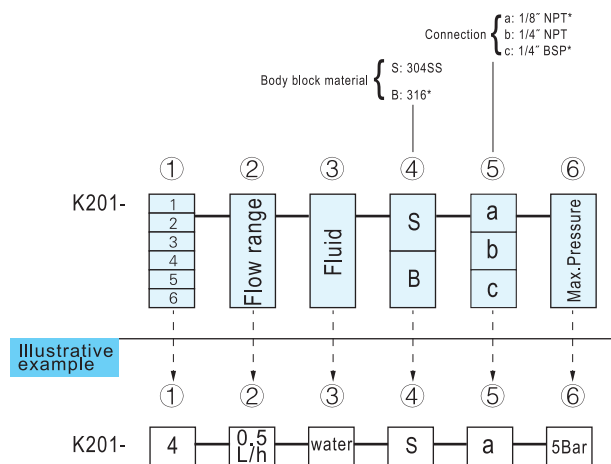

E

The wetted part is 304SS material. The flowmeter is used in chemical analysis apparatus, testing equipment and scientific development department, the flowmeter has small size and nice shape also it can be installed on equipment's control plate.

- Temperature limit: 60°C (Aluminum.), 100°C (304SS)
- Accuracy:  $\pm 2.5\%$
- Working pressure limit: 0.6MPa

### Specifications

Model	D N	Measuring range		Thread (Female)	Weights KG
		Water (mL/min)	Air (NmL/min)		
K-3011	DN3	2.5-25	3-30 6-60	1/8" NPT* 1/4" NPT	0.6(304)
K-3012	DN4	4-40	8-80 25-250 100-1000	1/4" NPT 1/4" BSP*	
K-3013	DN6	8-80 20-200 35-350 40-400 70-700 0.1-1 L/min	0.18-1.8NL/min 0.4-4NL/min 0.8-8NL/min 1.5-15NL/min 1.8-18NL/min 3-30NL/min		0.4(Al)

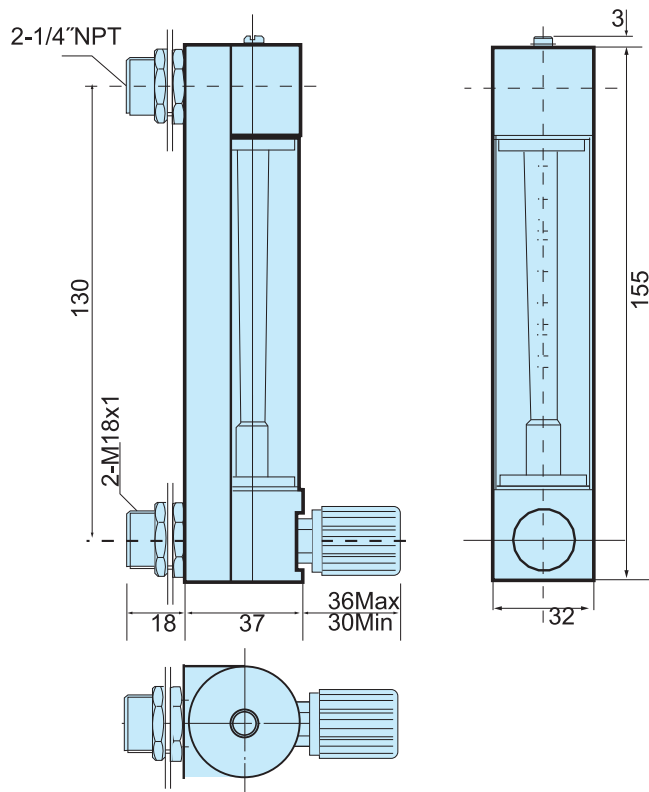

### K-300

### How to order

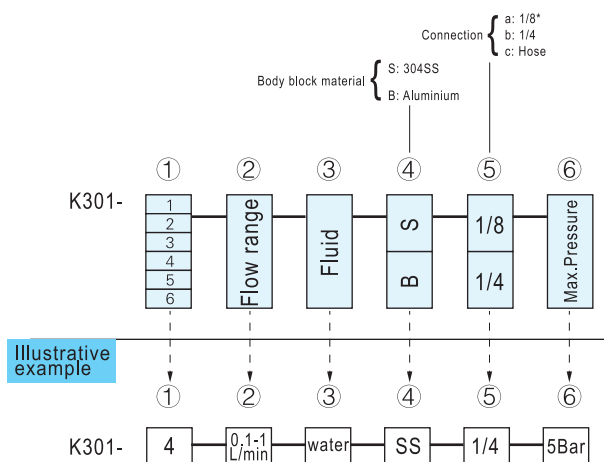

# K-400 Series

## Glass Rotameters

The wetted part is 304SS material. The flowmeter is used in chemical analysis apparatus, testing equipment and scientific development department, the flowmeter has small size and nice shape also it can be installed on equipment's control plate.

- Temperature limit: 60°C (Aluminium), 100°C (304SS.)
- Accuracy:  $\pm 2.5\%$
- Working pressure limit: 0.6MPa

### Specifications

Model	Measuring range		Thread (Female)	Weights KG
	Water (mL/min)	Air (NL/min)		
K-4011	20-200	0.3-3	1/8" NPT*	0.7(304SS) 0.5(AL)
K-4012	30-300	0.5-5	1/4" NPT	
K-4013	50-500	1-10	1/4" NPT	
K-4014	0.1-1 L/min	2-20		

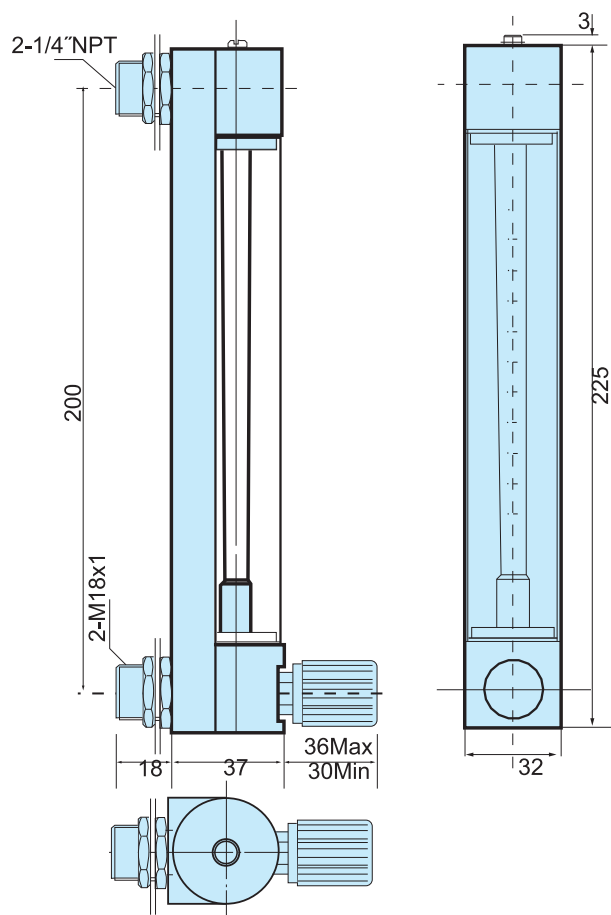

### K-400

### How to order

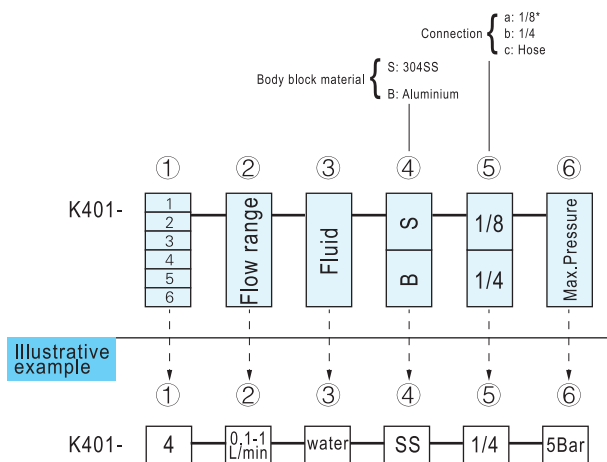

## Glass Rotameters

K-500 series Glass Rotameter consist of a tapered glass tube, both ends bases, and four  $\Phi 8$  holding studs, Easy installation, thread assembled and equipped with flow control valves. It is suitable for the small or large capacity flow measuring, i.e. semi-conductor chemical fluid etc.

- Temperature limit: PTFE (max 60°C)  
304SS (max 60°C)

Accuracy:  $\pm 5\%$

- Alarm switch is optional

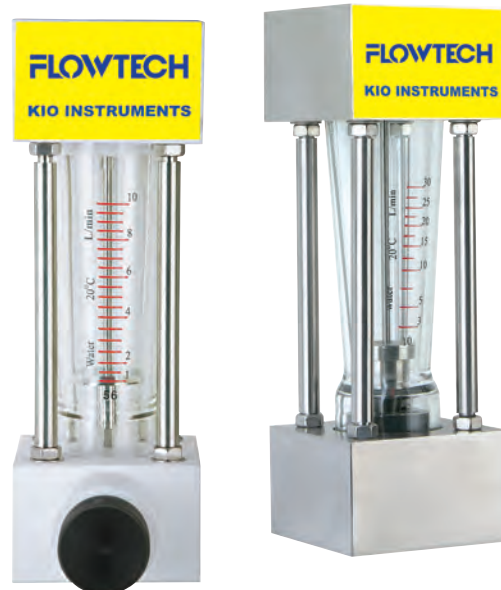

## Specifications

Model	Measuring Range		Thread (Female)	Weights(KG)	
	Water (L/min)	Air (NL/min)		304SS	PTFE
K-5011	1~10	40~400	1/2" NPT	2.5	1.5
K-5012	2~20	60~600			
K-5013	3~30	100~900			
K-5014	4~40	120~1200	3/4" NPT	2.5	1.5
K-5015	5~50	150~1500			
K-5016	12~60	400~1800			
K-5017	20~100	600~3000			

## K-500

## How to order

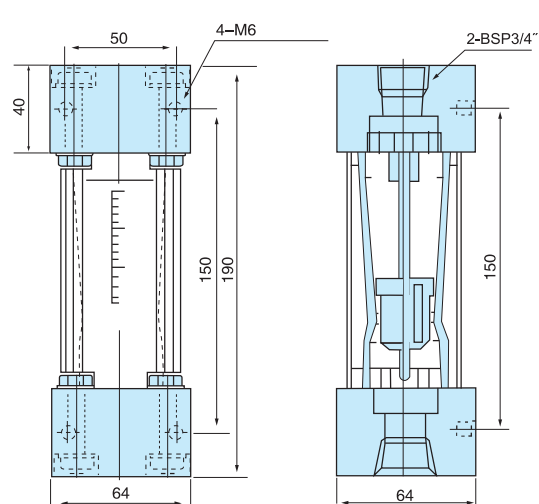
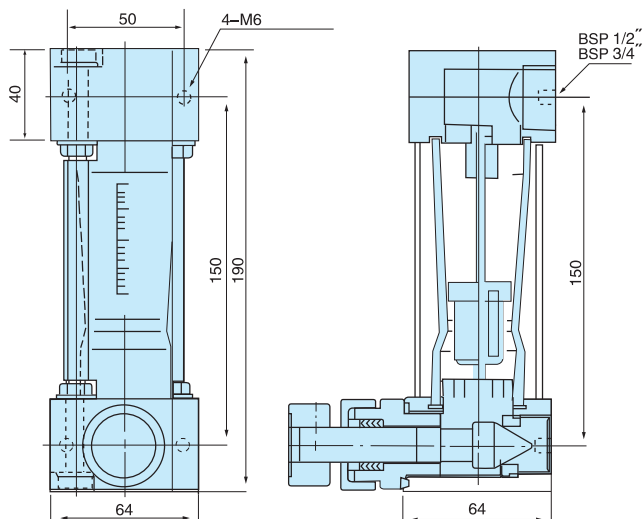
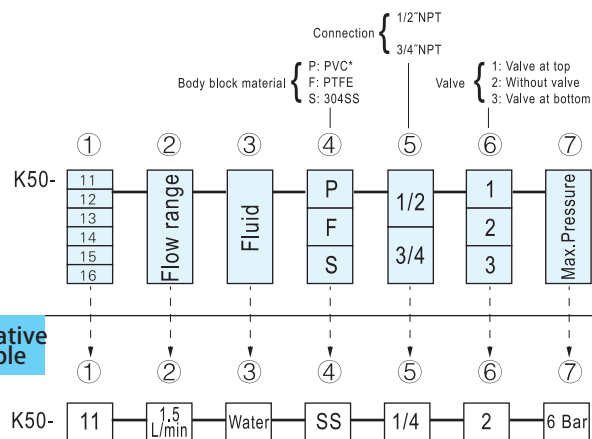

# K-500G Series

## Glass Rotameters

K-500G series glass rotameter consist of toper glass tube,float,top and bottom nuts,stainless steel body.it's easy to install,fittings can be optional of glue(PVC) and clamp.the flowmeter is used in ranges such as semi-conductor chemicals,etc

- Temperature limit:  $\leq 100^{\circ}\text{C}$
- Accuracy:  $\pm 2.5\%$
- Working pressure:  $\leq 0.6\text{MPa}$
- Alarm switch is optional



### Specifications

Model	Measuring Range		Thread (Female)  BSP/NPT	Tri- clamp	Weights(KG)
	Water (L/min)	Air (NL/min)			304SS
K-5011G	1~10	40~400	3/4"	Ø19	2.5
K-5012G	2~20	60~600			
K-5013G	3~30	90~900		Ø25	
K-5014G	4~40	120~1200			
K-5015G	5~50	150~1500	1"	Ø38	
K-5016G	12~60	400~1800			
K-5017G	20~100	600~3000			

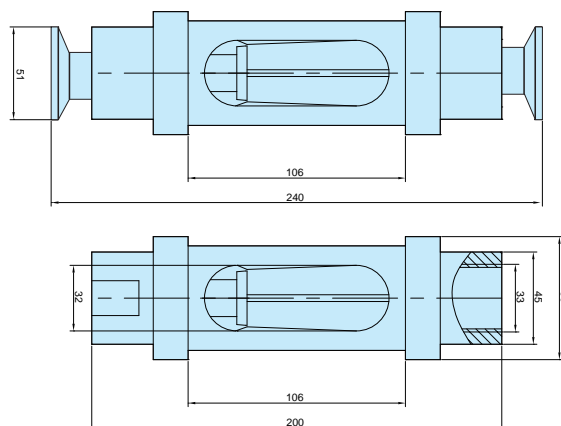

KF500G

How to order

